

Rear Wheel Brake
Cross-sectional View

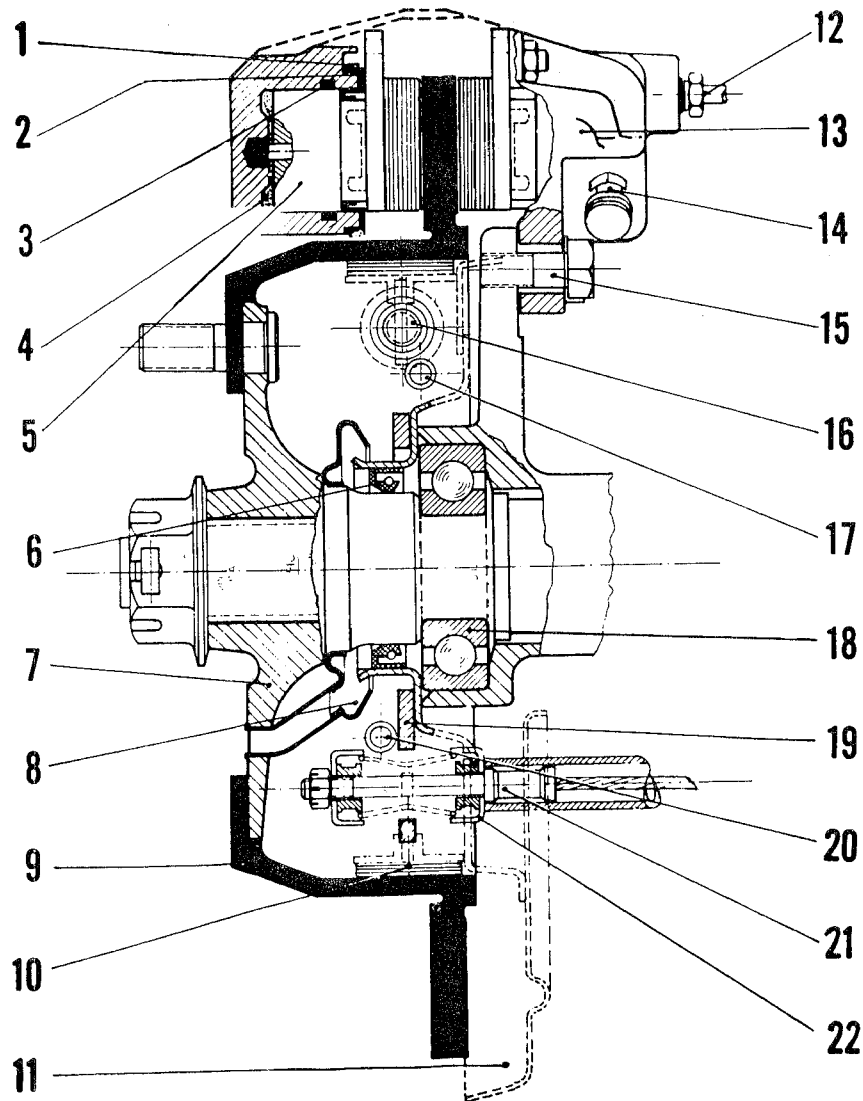

Fig. 4

- 1 Clamping ring
- 2 Dust cover
- 3 Piston seal
- 4 Brake fluid
- 5 Piston
- 6 Oil seal
- 7 Wheel hub
- 8 Oil deflector
- 9 Brake disc
- 10 Hand brake shoe
- 11 Disc shroud

- 12 Hydraulic line
- 13 Brake caliper
- 14 Bleeder valve
- 15 Retaining screw
- 16 Adjusting assembly
- 17 Return spring
- 18 Wheel bearing
- 19 Anchor plate
- 20 Return spring
- 21 Brake cable
- 22 Mechanical expander