

Removing and Installing Front Wheel Bearings

Removal

1. Mark brake disc and wheel hub, remove disc retaining bolts and withdraw wheel hub.

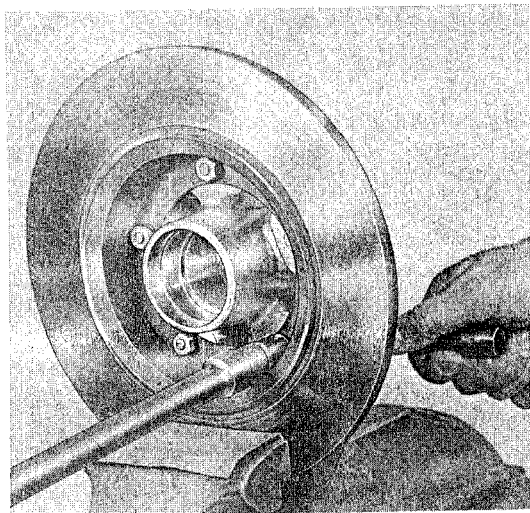

Fig. 17

2. Heat wheel hub to 120 - 150° C (248 - 270° F).

3. Press out inner taper-roller bearing and the seal on VW Press 400F, using special tools VW 407, VW 421 and VW 447g.

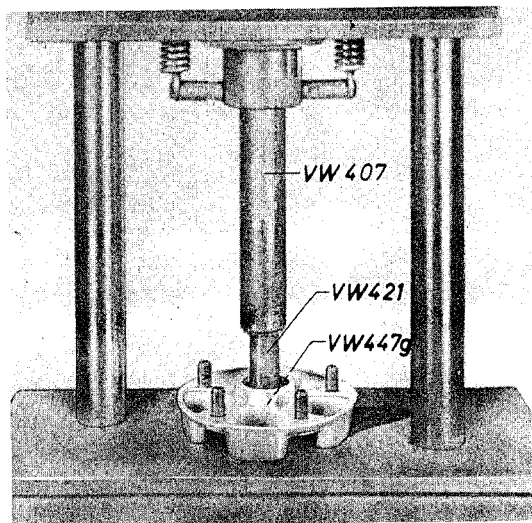

Fig. 18

4. Press out race of outer taper-roller bearing on VW Press 400 F, using special tools VW 407, VW 418, VW 447f, Spacer 1, and VW 401.

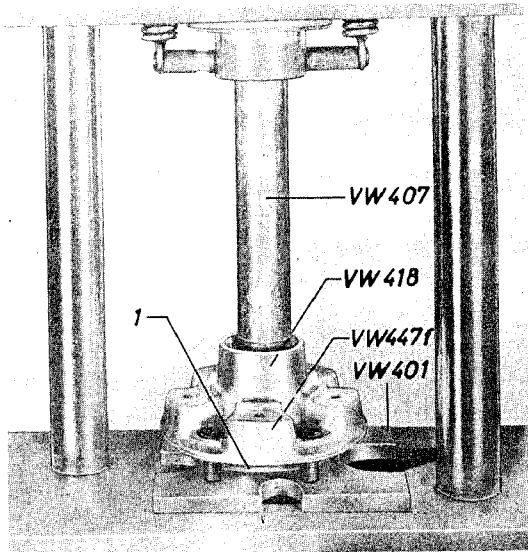

Fig. 19

Sketch for local manufacture of Spacer 1

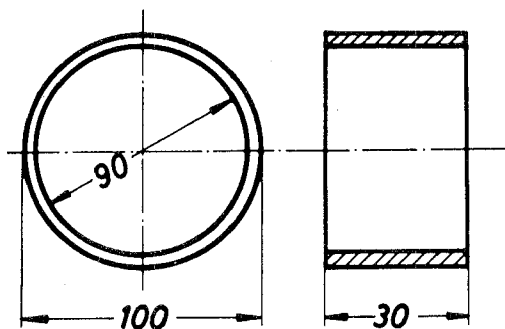

Fig. 20

90 mm = 3.54 in., 100 mm = 3.94 in., 30 mm = 1.18 in.

Installation

The following should be observed during installation:

General

Taper-roller bearings of various brands (SKF, FAG, and Timken) are used during assembly at the plant.

New bearing components, such as the outer race or the inner race with rollers, may be interchanged within a given brand but care must be taken that the complete bearing consists of components manufactured by the same company.

1. Thoroughly clean both taper-roller bearings and check for wear or damage, replace if necessary.
2. Heat wheel hub to 120 - 150° C (248 - 270° F).
3. Press in the race of the inner taper-roller bearing on VW Press 400 F, using special tools VW 407, VW 447i, Spacer 1, and VW 401.

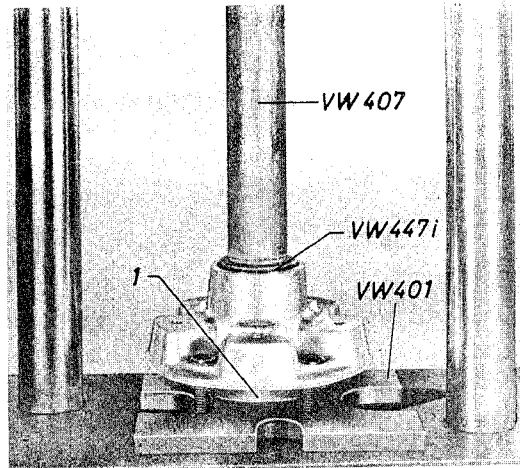

Fig. 21

4. Insert the inner race into the inner taper-roller bearing and press oil seal on VW Press 400 F, using special tools VW 410, VW 433, Spacer 1, and VW 401 until the oil seal is flush with the wheel hub housing.
5. Press in the outer race of the outer taper-roller bearing on VW Press 400 F, using special tools VW 407, VW 447h, and VW 401.

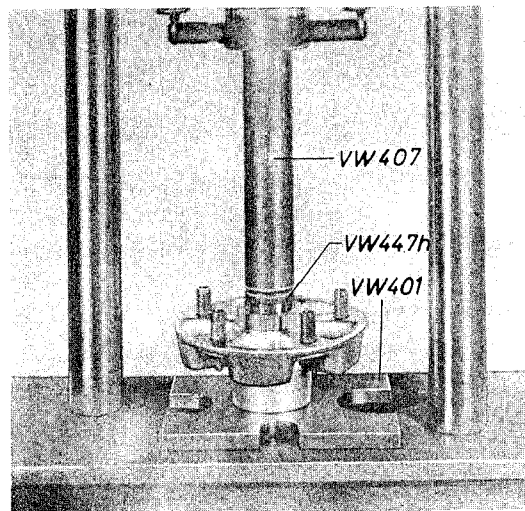

Fig. 22

6. Fill wheel hub with about 50 cm³ or 45 g (3 cu. in. or 1 1/2 oz.) of multi-purpose Lithium grease as in the lubrication plan.
7. Place brake disc on the wheel hub so that the markings line up.
8. Tighten brake disc retaining bolts (at wheel hub) to 2, 2 - 2, 4 mkg (15. 9 - 17. 4 lbs/ft). Make certain that 1 spacer is placed under the bolt head and a new spring washer is placed under the nut.